

EXHIBIT "A"

PROJECT: 0710750
CODE: 5269
PARCEL NO.: 220-Excess Land

Sheet 1 of 1

A Part of the South Half of the Southwest Quarter of Section 2, Township 36 North, Range 2 East, St. Joseph County, Indiana and being that land within the lines depicted on the attached Parcel Plat, marked **EXHIBIT "B"**, described as follows: Commencing at the southwest corner of said section; thence South 88 degrees 39 minutes 32 seconds East 2,033.31 feet along the south line of said section; thence continuing South 88 degrees 39 minutes 32 seconds East 396.45 feet along said line; thence North 0 degrees 20 minutes 53 seconds East 139.42 feet to the point of beginning of this description said point being on the east boundary of U.S. 31; thence North 20 degrees 17 minutes 47 seconds West 301.78 feet along said boundary; thence North 9 degrees 54 minutes 31 seconds West 459.94 feet along said boundary; thence North 4 degrees 08 minutes 11 seconds East 279.81 feet along said boundary; thence North 23 degrees 04 minutes 44 seconds East 193.01 feet along said boundary; thence South 88 degrees 49 minutes 42 seconds East 95.24 feet; thence South 0 degrees 20 minutes 53 seconds West 1,190.83 feet to the place of beginning and containing 3.563 acres, more or less.

TOGETHER with the permanent extinguishment of all rights and easements of ingress and egress to, from, and across the limited access facility (to be known as U.S. 31 and as Project 0710750), to and from the grantor's remaining lands along the lines described as follows: the 301.78-foot, the 459.94-foot, the 279.81-foot and the 193.01-foot courses described above. . This restriction shall be a covenant running with the land and shall be binding on all successors in title to the said abutting lands.

This description was prepared for the Indiana Department of Transportation, by Fred L. Bengé, Indiana Registered Land Surveyor, License Number LS80040408, on the 14th day of February, 2017





Fred L. Bengé

EXHIBIT "B" PARCEL PLAT

PREPARED BY CHA COMPANIES
FOR THE INDIANA DEPARTMENT OF TRANSPORTATION

SHEET 1 OF 1

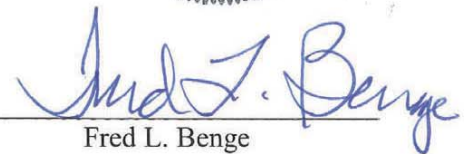
0 50 100 200

SCALE: 1" = 200'

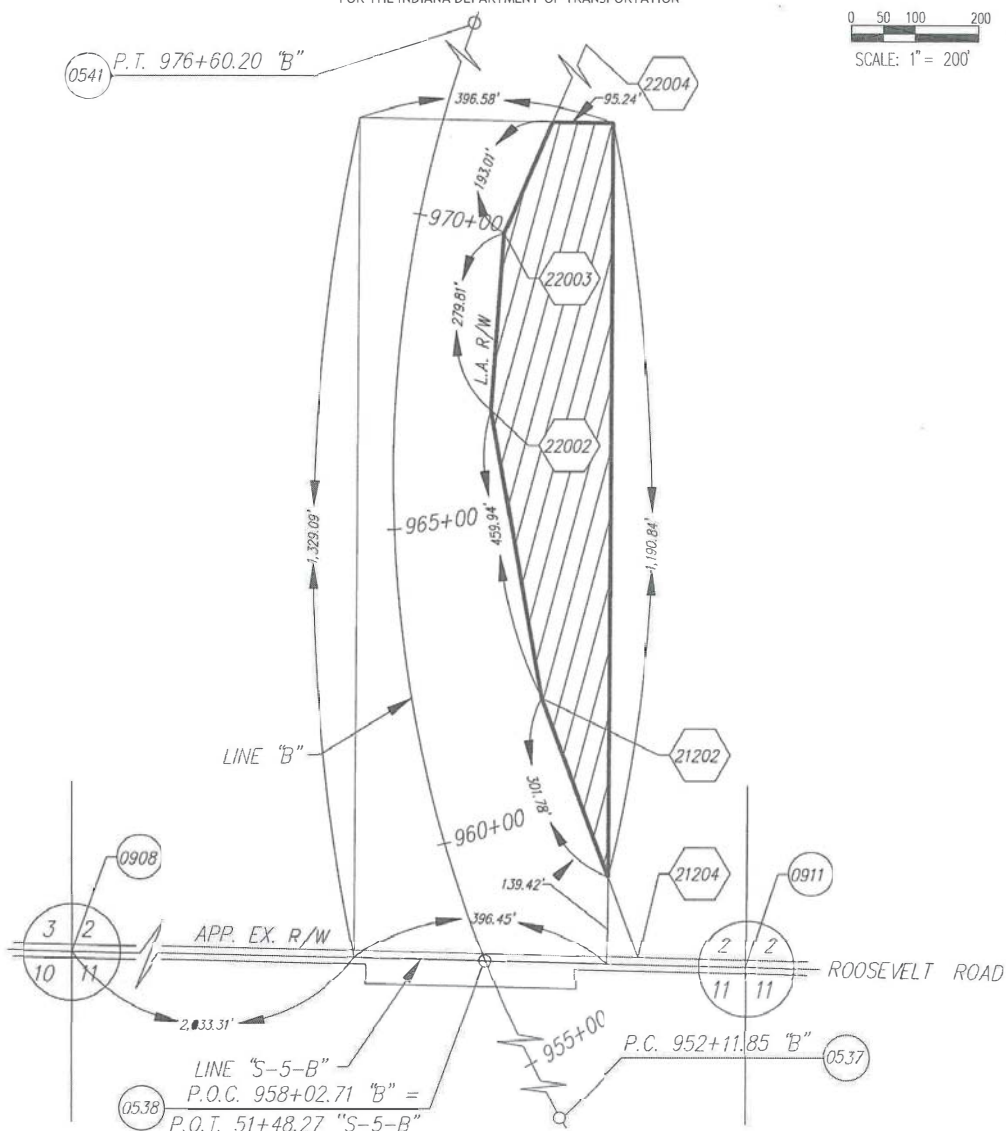

PARCEL COORDINATE CHART

Point	Line	Station	Offset	NORTH	EAST
0537*	N/A	----	----	----	----
0538*	N/A	----	----	----	----
0541*	N/A	----	----	----	----
0908*	N/A	----	----	----	----
0911*	N/A	----	----	----	----
21202	"B"	962+00.00	200.00' RT.	92833.9391	60689.9157
21204	"B"	957+10.31	223.82' RT.	92421.3345	60842.5121
22002	"B"	967+00.00	150.00' RT.	93287.0171	60610.7707
22003	"B"	970+00.00	135.00' RT.	93566.0938	60630.9529
	"B"	976+60.20	165.00' RT.	94128.4116	60870.5571

NOTE: STATIONS & OFFSETS CONTROL OVER BOTH NORTH & EAST
COORDINATES AND BEARINGS & DISTANCES.

* SEE LOCATION CONTROL ROUTE SURVEY PLAT.

SURVEYOR'S STATEMENT

To the best of my knowledge and belief, this plat, together with the "Location Control Route Survey" recorded in Instrument No. 0654538 in the Office of the Recorder of St. Joseph County, Indiana, (incorporated and made a part hereof by reference) comprise a Route Survey executed in accordance with Indiana Administrative Code 865 IAC 1-12, ("Rule 12").

OWNER : STATE OF INDIANA
PARCEL : 220
CODE : 5269
PROJECT : 0710750
ROAD : U.S. 31
COUNTY : ST. JOSEPH
SECTION : 2
TOWNSHIP : 36N.
RANGE : 2E.

DRAWN BY:
CHECKED BY:
DES: 0710755



HATCHED AREA IS THE
APPROXIMATE EXCESS LAND



Fred L. Bengt
2-14-17